



Industrial installations

Connection systems



Contents



PA

HoverCube VH-4, 4x protective contact socket

Type	Colour	Pack Piece	Weight kg/100 pc.	Item no.
VH-4 4SD	Graphite black	1	95.000	6109802

Housing equipped and pre-wired with suspension lug, grip hook and four cover plates.

Equipped as follows: 4x single protective contact sockets 16 A/250 V with increased touch protection, pre-wired for two AC currents, connection via 2x 3-pin terminals, 1x CEE socket 16 A/415 V, with partition for circuit separation.

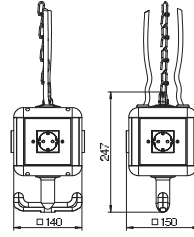

PA

HoverCube VH-4, 3x protective contact socket, 1x CEE 16 A

Type	Colour	Pack Piece	Weight kg/100 pc.	Item no.
VH-4 3SD1C16	Graphite black	1	115.700	6109804

Housing equipped and pre-wired with suspension lug, grip hook and four cover plates.

Equipped as follows: 3x single protective contact sockets 16 A/250 V with increased touch protection, pre-wired for an AC current, connection via 1x 3-pin terminal, 1x CEE socket 16 A/415 V, with partition for circuit separation.

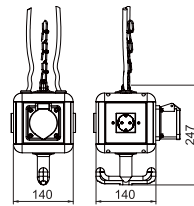

Positioner for VH power supply units

Type	Designation	Colour	Pack Piece	Weight kg/100 pc.	Item no.
VH-POS	Up to 6 kg load capacity	Orange	1	80.000	6109887

Positioner for variable height adjustment of a VH power supply unit, support load between 0.5 and 6.0 kg, maximum cable draw-out 1.5 m.

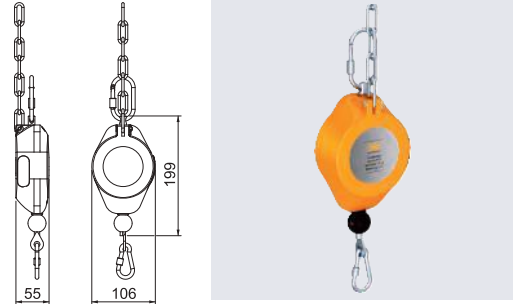

VA 2B

Type	Designation	Pack Piece	Weight kg/100 pc.	Item no.
VH-F100VA		1	31.000	6109829

Tension spring for VH/VHF power supply units, with German eyelet.

Fmax. = 100 N
 L0 = 200 mm
 Ln = 500 mm (for Fmax.)
 Material: VA ϕ 3.0 mm

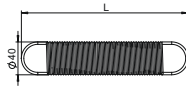

St

Type	Designation	Pack m	Weight kg/100 m	Item no.
VH-K800	Sold by the metre	1	20.000	6109870

Knotted chain made of pre-copper-plated steel, nickel-plated, according to DIN 5686.
 Max. tensile force: 800 N.

Note: Specify the required chain length during ordering.

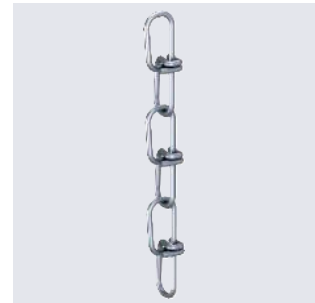
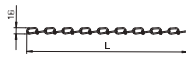

Knotted chain

VH cover plate as blanking cover

PA

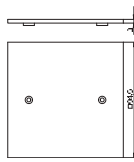

Colour		Pack	Weight	Item no.
Type	Piece	kg/100 pc.	pc.	
VH-P1	Rape yellow	1	2.930	6109842

Cover plate as blanking cover.

VH cover plate, for 1x extension socket, type ASD

PA

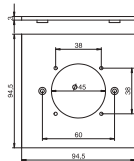

Colour		Pack	Weight	Item no.
Type	Piece	kg/100 pc.	pc.	
VH-P7	Rape yellow	1	1.890	6109839

Cover plate with opening for the installation of a socket with 38 x 38 mm fastening system.

Cover plate VH, for CEE connection unit

PA

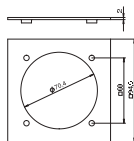
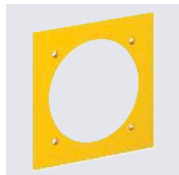

Colour		Pack	Weight	Item no.
Type	Piece	kg/100 pc.	pc.	
VH-P3	Rape yellow	1	1.830	6109838

Cover plate with a $\varnothing 70$ mm opening for the installation of a CEE socket 16/32 A with 60 mm fastening track, including four fastening screws.

Information on equipment:

Max. 2 CEE sockets 16/32 A in a power supply unit VH-4

Max. 4 CEE sockets 16/32 A in a power supply unit VH-8

Cover plate VH, for EK and EKR devices

PA

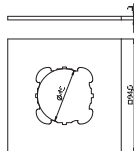
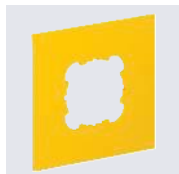

Colour		Pack	Weight	Item no.
Type	Piece	kg/100 pc.	pc.	
VH-P2	Rape yellow	1	2.300	6109834

Cover plate with opening $\varnothing 45$ mm for the installation of a device with concealed support ring or support clamp.

VH cover plate, for Modul 45 devices, single

PA

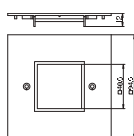

Colour		Pack	Weight	Item no.
Type	Piece	kg/100 pc.	pc.	
VH-P4	Rape yellow	1	2.030	6109840

Cover plate to install a single Modul 45 socket.

St FT

Type	Length mm	Pack Piece	Weight kg/100 pc.	Item no.
MAS 140 10 FT	1400	1	505.000	6356311

Vertical motor connection column to supply electrical devices.

Motor connection column

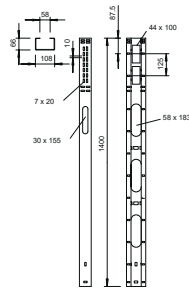

Accessories, motor connection columns

St FT

Type	Length mm	Pack Piece	Weight kg/100 pc.	Item no.
MASD 90 FT	900	1	160.000	6356915

Cover with turn buckle for motor connection column.

Cover for motor connection column

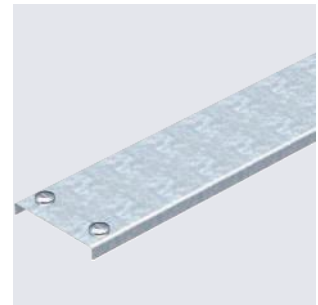
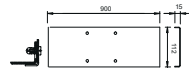

St FT

Type	Pack Piece	Weight kg/100 pc.	Item no.
SF 140 11 FT	1	200.000	6356397

Column foot for fastening of the motor connection column.

Column foot

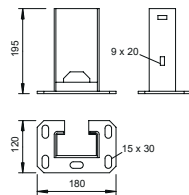

St FT

Type	Pack Piece	Weight kg/100 pc.	Item no.
BF 140 10 FT	10	50.000	6356362

Mounting bracket for side fastening of motor connection columns to bases or on the wall.

Mounting bracket

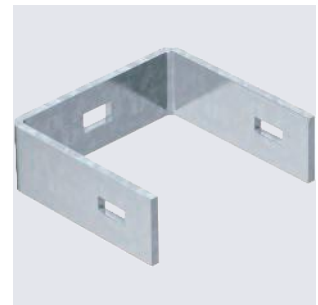
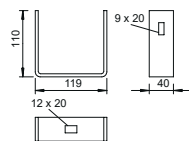

Junction box A 6



	Type	A 6	A 6 HF RW
Colour	Light grey	Pure white	Red
Dimension LxWxH mm	80x43x36	80x43x36	80x43x36
Clear internal dimensions mm	69x32x30	69x32x30	69x32x30
Pack Piece	10	10	10
Weight kg/100 pc.	2.560	2.560	2.560
Item no.	2000001	2000005	2000003

PE Polyethylene

Protection rating IP55, rated voltage 400 V, nominal cross-section 2.5 ÷ mm², 6 entries for cable diameter 5–14 mm
 4 entries for cable diameter 5–9 mm.
 Clamshell.
 Dimensions: 80 x 43 x 36 mm
 Clear internal dimensions: 69 x 32 x 30 mm
 1 cut-out tool for every 10 boxes

Junction box A 8



	Type	A 8	A 8 HF RW
Accessories	without terminal strip	without terminal strip	without terminal strip
Colour	Light grey	Pure white	Red
Dimension LxWxH mm	75x75x36,2	75x75x36,2	75x75x36,2
Clear internal dimensions mm	65x65x32	65x65x32	65x65x32
Pack Piece	10	10	10
Weight kg/100 pc.	3.649	5.140	5.140
Item no.	2000016	2000075	2000059

PE Polyethylene

Protection rating IP55, rated voltage 400 V, nominal cross-section 2.5 ÷ mm², 7 entries for cable diameters of 5–14 mm.
 Clamshell.
 Dimensions: 75 x 75 x 36.2 mm
 Clear internal dimensions: 65 x 65 x 32 mm
 1 cut-out tool for every 10 boxes

PP



Junction box T 25, plug-in seal, flame-resistant

Type	Colour	Entries	Dimension LxWxH mm	Clear internal dimensions mm	Pack Piece	Weight kg/100 pc.	Item no.
T 25 F	Light grey	4xM25	Ø80x51	Ø63x45	5	4.190	2007312

Junction box for the connection of cables and lines indoors and in protected outdoor areas. Round design with plug-in seals to the sides and knock-out entries in the bottom. Suitable for wall and ceiling mounting, on mounting panels and threads in the floor. With the option to fasten inside. With fixed clamping cover. Made from halogen-free materials. Flame-resistant type made from special polypropylene. Junction box according to DIN EN 60670. Flame-resistant to DIN EN 60695-2-11, test temperature 960 °C. Impact resistance IK07 according to DIN EN 50102.

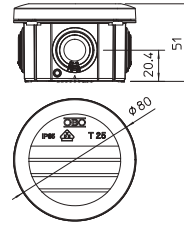

PP



Junction box T 40, plug-in seal, flame-resistant

Type	Colour	Entries	Dimension LxWxH mm	Clear internal dimensions mm	Pack Piece	Weight kg/100 pc.	Item no.
T 40 F	Light grey	7xM25	90x90x52	77x77x46	5	6.700	2007320

Junction box for the connection of cables and lines indoors and in protected outdoor areas. Square design with plug-in seals to the sides and knock-out entries in the bottom. Suitable for wall and ceiling mounting and on mounting panels. With the option to fasten inside. With fixed clamping cover. Flame-resistant type made from special polypropylene. Junction box according to DIN EN 60670. Flame-resistant to DIN EN 60695-2-11, test temperature 960 °C. Impact resistance IK07 according to DIN EN 50102.

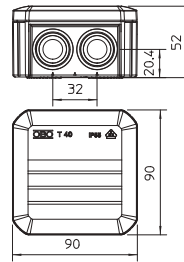

PP



Junction box T 60, plug-in seal, flame-resistant

Type	Colour	Entries	Dimension LxWxH mm	Clear internal dimensions mm	Pack Piece	Weight kg/100 pc.	Item no.
T 60 F	Light grey	7xM25	114x114x57	100x100x48	5	12.300	2007339

Junction box for the connection of cables and lines indoors and in protected outdoor areas. Square design with plug-in seals to the sides and knock-out entries in the bottom. Suitable for wall and ceiling mounting and on mounting panels. With the option to fasten inside and to mount via the corner domes. Cover with quick lock, sealable. Made from halogen-free materials. Flame-resistant type made from special polypropylene. Junction box according to DIN EN 60670. Flame-resistant to DIN EN 60695-2-11, test temperature 960 °C. Impact resistance IK07 according to DIN EN 50102.

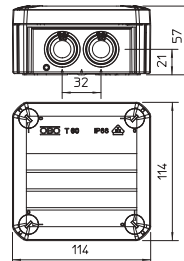

PP

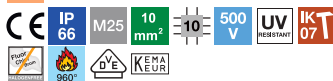

Junction box T 100, plug-in seal, flame-resistant

Type	Colour	Entries	Dimension LxWxH mm	Clear internal dimensions mm	Pack Piece	Weight kg/100 pc.	Item no.
T 100 F	Light grey	10xM25	150x116x67	136x102x57	1	16.270	2007347

Junction box for the connection of cables and lines indoors and in protected outdoor areas. Rectangular design with plug-in seals to the sides and knock-out entries in the bottom. Suitable for wall and ceiling mounting and on mounting panels. With the option to fasten inside and to mount via the corner domes. Cover with quick lock, sealable. Made from halogen-free materials. Flame-resistant type made from special polypropylene. Junction box according to DIN EN 60670. Flame-resistant to DIN EN 60695-2-11, test temperature 650 °C. Impact resistance IK07 according to DIN EN 50102.

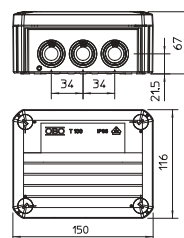

Junction box X 01



Type	X01 LGR	X01 LGR-TR	X01 SW	X01 SW-RO
Colour	Light grey	Grey/transparent	Graphite black	Black/red
Entries	7 x Ø20	7 x Ø20	7 x Ø20	7 x Ø20
Dimension LxWxH mm	95x95x60	95x95x60	95x95x60	95x95x60
Clear internal dimensions mm	85x85x45	85x85x45	85x85x45	85x85x45
Pack Piece	1	1	1	1
Weight kg/100 pc.	16.000	16.000	16.000	16.000
Item no.	2005000	2005050	2005110	2005140

PC Polycarbonate

Junction box for the connection of cables and lines indoors and in outdoor areas. Square design with knock-out entries. Suitable for wall and ceiling mounting with the option to fasten outside, inside or to mount via the corner domes. Particularly impact resistant with IK09. Cover with quick lock, sealable. Made from halogen-free and UV-resistant materials.

Junction box according to DIN EN 60670. Flame-resistant to DIN EN 60695/2/11, test temperature 650 °C. Impact resistance IK09 according to DIN EN 50102. Protection rating IP67 according to DIN EN 60529.

The junction box fulfils the protection type test requirements to IP 67 according to DIN EN 60529, VDE0470-1:2014 (EN 60529/AC:2016).

The junction box is tested according to DIN EN 60670-1, VDE 0606-1:2014 (EN 60670-1:2005 + Cor.:2007 + Cor.:2010 + A1:2013) and DIN EN 60670-22, VDE 0606-22:2007 (EN 60670-22:2006).

Junction box X 02



Type	X02 LGR	X02 LGR-TR	X02 SW	X02 SW-RO
Colour	Light grey	Grey/transparent	Graphite black	Black/red
Entries	7 x Ø20	7 x Ø20	7 x Ø20	7 x Ø20
Dimension LxWxH mm	95x95x72	95x95x72	95x95x72	95x95x72
Clear internal dimensions mm	85x85x57	85x85x57	85x85x57	85x85x57
Pack Piece	1	1	1	1
Weight kg/100 pc.	17.800	17.800	17.800	17.800
Item no.	2005004	2005054	2005114	2005144

PC Polycarbonate

Junction box for the connection of cables and lines indoors and in outdoor areas. Square design with knock-out entries. Suitable for wall and ceiling mounting with the option to fasten outside, inside or to mount via the corner domes. Particularly impact resistant with IK09. Cover with quick lock, sealable. Made from halogen-free and UV-resistant materials.

Junction box according to DIN EN 60670. Flame-resistant to DIN EN 60695/2/11, test temperature 650 °C. Impact resistance IK09 according to DIN EN 50102. Protection rating IP67 according to DIN EN 60529.

The junction box fulfils the protection type test requirements to IP 67 according to DIN EN 60529, VDE0470-1:2014 (EN 60529/AC:2016).

The junction box is tested according to DIN EN 60670-1, VDE 0606-1:2014 (EN 60670-1:2005 + Cor.:2007 + Cor.:2010 + A1:2013) and DIN EN 60670-22, VDE 0606-22:2007 (EN 60670-22:2006).

Aluminium empty housing Mx06-Mx15, powder-coated



Type	Mx 060503 SGR	Mx 080705 SGR	Mx 120805 SGR	Mx 161008 SGR
Version	Closed with 4 stainless steel lid screws	Closed with 4 stainless steel lid screws	Closed with 4 stainless steel lid screws	Closed with 4 stainless steel lid screws
Colour	Silver grey	Silver grey	Silver grey	Silver grey
Dimension LxWxH mm	64x58x34	80x75x57	125x80x57	160x100x81
Clear internal dimensions mm	56.5x50.5x31.5	71x65.6x52.5	115.5x70.5x51	117x90x74.5
Pack Piece	1	1	1	1
Weight kg/100 pc.	19.200	36.400	50.000	90.000
Item no.	2011304	2011308	2011312	2011316
	AIG Die-cast aluminium P Powder-coated			

Robust aluminium empty housing for mechanical engineering and automation technology. The OBO Mx series' excellent mechanical and thermal features make it most suitable for extreme demands in many different areas. It is therefore also best suited for applications in industry, ports and shipbuilding, as well as in the agricultural sector. The products protect the electrical installation against high-grade strains. They withstand both extreme cold and heat as well as vandalism and impact on roads, railways or in tunnels. With an IP66 protection class, they are optimally protected against the intrusion of dust and water. The aluminium housings are plastic coated (RAL 7035) and are delivered with a cover including stainless steel screws, a seal and two or four earthing screws.

Temperature: -40°C to +125°C

Aluminium empty housing Mx06-Mx15, powder-coated



Type	Mx 161609 SGR	Mx 170805 SGR	Mx 261609 SGR	Mx 361609 SGR
Version	Closed with 4 stainless steel lid screws	Closed with 4 stainless steel lid screws	Closed with 4 stainless steel lid screws	Closed with 4 stainless steel lid screws
Colour	Silver grey	Silver grey	Silver grey	Silver grey
Dimension LxWxH mm	160x160x90	175x80x57	260x160x90	360x160x91
Clear internal dimensions mm	149x149x84.5	165x70x51	229.5x149x94.5	317.5x149x92
Pack Piece	1	1	1	1
Weight kg/100 pc.	170.000	66.000	230.000	320.000
Item no.	2011320	2011324	2011328	2011332
	AIG Die-cast aluminium P Powder-coated			

Robust aluminium empty housing for mechanical engineering and automation technology. The OBO Mx series' excellent mechanical and thermal features make it most suitable for extreme demands in many different areas. It is therefore also best suited for applications in industry, ports and shipbuilding, as well as in the agricultural sector. The products protect the electrical installation against high-grade strains. They withstand both extreme cold and heat as well as vandalism and impact on roads, railways or in tunnels. With an IP66 protection class, they are optimally protected against the intrusion of dust and water. The aluminium housings are plastic coated (RAL 7035) and are delivered with a cover including stainless steel screws, a seal and two or four earthing screws.

Temperature: -40°C to +125°C

PP
E30 E60 E90 IP 66

FireBox T100ED with plug-in seal and internal fastening

Type	Nominal cross-section mm ²	Number of terminals	Entries	Pack Piece	Weight kg/100 pc.	Item no.
T 100 ED 4-5	4	5	8xM25 2xM32	1	34.600	7205529
T 100 ED 6-5	6	5	8xM25 2xM32	1	34.000	7205530
T 100 ED 10-5	10	5	8xM25 2xM32	1	35.900	7205533

Halogen-free junction box with pre-mounted, soft plug-in seals, approved for maintaining electrical functionality according to DIN 4102 Part 12. Maintenance of electrical functionality to classes E30 to E90.

Colour: Pastel orange.

Including pre-mounted connection unit made of high temperature-resistant special ceramic and labelled protective conductor terminal. Supplied with 2 MMS 6x50 fire protection screw ties for anchorless fastening. Power cable nominal cross-sections: 1.5 to 10 mm² depending on the type, data cables with 0.8 mm wire Ø. Several rigid copper wires with smaller cross-sections per terminal possible. High protection rating IP66, impact resistance class IK08.

Details on the cable types and manufacturers can be found in the general construction test certificate of the material testing institute NRW, Erwitte.

Number of terminals including protective conductor terminal.
Internal clearance: 136x102x57 mm.

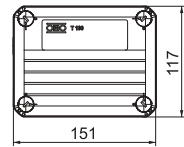
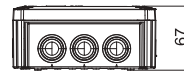

PP
E30 E60 E90 IP 66

FireBox T160ED with internal fastening

Type	Nominal cross-section mm ²	Number of terminals	Entries	Pack Piece	Weight kg/100 pc.	Item no.
T 160 ED 16-5	16	5	7xM25 5xM32	1	62.500	7205536

Halogen-free junction box with pre-mounted, soft plug-in seals, approved for maintaining electrical functionality according to DIN 4102 Part 12. Maintenance of electrical functionality to classes E30 to E90.

Colour: Pastel orange.

Including pre-mounted connection unit made of high temperature-resistant special ceramic and labelled protective conductor terminal. Supplied with 2 MMS 6x50 fire protection screw ties for anchorless fastening. Power cable nominal cross-sections: Up to 16 mm². Several rigid copper wires with smaller cross-sections per terminal possible. High protection rating IP66, impact resistance class IK05.

Details on the cable types and manufacturers can be found in the general construction test certificate of the material testing institute NRW, Erwitte.

Number of terminals including protective conductor terminal.
Internal clearance: 176x135x67 mm.

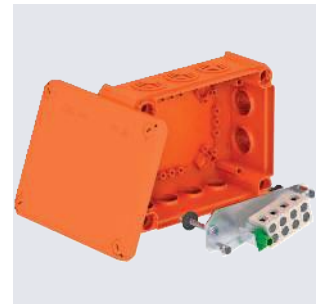
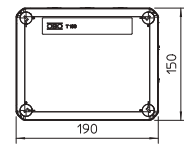
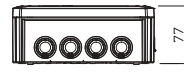



Aquasit cold casting compound, cartridge

Type	Contents ml	Pack Piece	Weight kg/100 pc.	Item no.
KVM 250	250	1	42.000	2363010

Aquasit is a two-component casting compound for junction boxes in areas with continuous and extremely high levels of moisture. It can also be used against mechanical shock and vibrations.

The cartridge is suitable for use in standard cartridge pistols. At room temperature, the unopened aluminium packaging can be stored for up to 18 months. When the cartridge is opened, the material should be used within 24 hours. Practical experience, tests and approvals only apply in conjunction with OBO junction boxes.

Aquasit properties:
 Protection rating with appropriate junction box: IP68 at 1.8 bar/1,000 hrs
 Rated voltage: 400 V
 Penetration resistance: >20 kV/mm to VDE 0291 Part 2
 Operating temperature: -40 to +90 °C
 Processing temperature: 0 to +40 °C
 Halogen-free, silicon-free, isocyanate-free
 Environmentally friendly and without the need to be labelled

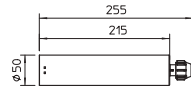

PP



Aquasit cold casting compound with T40 junction box

Type	Version	Entries	Shipping box Piece	Pack Piece	Weight kg/100 pc.	Item no.
T 40 KVM	With terminal strip	7 x M25	1	1	48.700	2363012

Aquasit is a two-component casting compound in a cartridge, for applications in areas with continuous and extremely high levels of moisture. It can also be used against mechanical shock and vibrations.

The cartridge is suitable for use in standard cartridge pistols. At room temperature, the unopened aluminium packaging can be stored for up to 18 months. When the cartridge is opened, the material should be used within 24 hours. Practical experience, tests and approvals valid only in conjunction with OBO junction boxes.

Aquasit properties:
 Protection rating with appropriate junction box: IP68 at 1.8 bar/1,000 hrs
 Rated voltage: 400 V
 Penetration resistance: >20 kV/mm to VDE 0291 Part 2
 Operating temperature: -40 to +90 °C
 Processing temperature: 0 to +40 °C
 Halogen-free, silicon-free, isocyanate-free
 Environmentally friendly and without the need to be labelled



Aquasit cold casting compound, mixing bag

Type	Contents ml	Pack Piece	Weight kg/100 pc.	Item no.
KVMM 400	400	1	49.800	2363008
KVMM 800	800	1	92.000	2363006
KVMM 1600	1600	1	175.000	2363002

Aquasit is a two-component casting compound for junction boxes in areas with continuous and extremely high levels of moisture. It can also be used against mechanical shock and vibrations.

At room temperature and when stored properly, the unopened aluminium bag can be used for up to 18 months. When the bags are mixed, the material should be used within 20 minutes. Practical experience, tests and approvals only apply in conjunction with OBO junction boxes.

Aquasit properties:
 Protection rating with appropriate junction box: IP68 at 1.8 bar/1000 hrs
 Rated voltage: 400 V
 Penetration resistance: >20 kV/mm to VDE 0291 Part 2
 Operating temperature: -40 to +90 °C
 Processing temperature: 0 to +40 °C
 Halogen-free, silicon-free, isocyanate-free
 Environmentally friendly and without the need to be labelled





Cap nut cable gland, metric thread, light grey

Type	Colour	Shipping box Piece	Pack Piece	Weight kg/100 pc.	Item no.
V-TEC VM12 LGR	Light grey	500	50	0.318	2022862
V-TEC VM16 LGR	Light grey	500	50	0.638	2022864
V-TEC VM20 LGR	Light grey	600	50	0.856	2022866
V-TEC VM25 LGR	Light grey	300	25	1.360	2022868
V-TEC VM32 LGR	Light grey	240	20	2.235	2022870
V-TEC VM40 LGR	Light grey	120	10	3.467	2022872
V-TEC VM50 LGR	Light grey	60	5	5.466	2022874
V-TEC VM63 LGR	Light grey	60	5	8.306	2022876



The quickest and most convenient way of providing strain relief and tightness with cable glands on junction boxes and housings is with the tried-and-trusted V-TEC VM cable glands from OBO. A protection rating of IP68 is achieved through the integrated sealing lip and the special OBO slat technology. Strain relief and tightness have been tested to DIN EN 62444. The connecting threads of the cable glands are metric or PG and are therefore suitable for universal use. Once screwed in place, the installation is there forever, as the optimum thread adjustment with the right pitch ensures permanent resistance to shaking. Applications: from private housing with junction boxes up to industrial applications in the distributor cabinet. Temperature range: -20 °C to +65 °C.

Type	Thread	Sealing range		Dim.		Dim.		Dim.	Dim.	In-stal-lation torque Nm
		D	SW	E	min.	max.	L1			
V-TEC VM12 LGR	M12x1,5	3.5-7	15	16.5	18.5	23.5	8	5	2	
V-TEC VM16 LGR	M16x1,5	4.5-10	20	22	21.5	23.5	8	5	2	
V-TEC VM20 LGR	M20x1,5	6-13	24	27	23.5	30.5	9	5	3.8	
V-TEC VM25 LGR	M25x1,5	9-17	29	32	26	35	10	6	5	
V-TEC VM32 LGR	M32x1,5	15-21	36	41	29	40	11	6	7.5	
V-TEC VM40 LGR	M40x1,5	16-28	44	50	36	46	11	7	10	
V-TEC VM50 LGR	M50x1,5	23-35	54	60	43	52	12	8	12	
V-TEC VM63 LGR	M63x1,5	36-48	67	75	48	60	12	9	15	

Dimensions

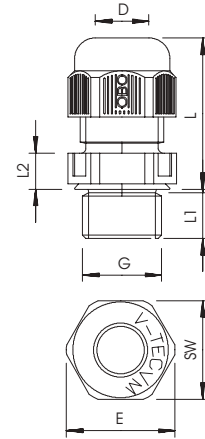

PC



Divisible cable gland, seal insert enclosed, light grey

Type	Colour	Shipping box		Pack Piece	Weight kg/100 pc.	Item no.
		Piece				
V-TEC TB20	Light grey	50		5	2.236	2024940

The splittable cable gland V-TEC TB.. ensures - like all V-TEC glands - a secure sealing of the cable. The installation of pre-terminated cables or function cables, for example, is easy and quick, thanks to the splitting of the cable gland.
The V-TEC TB is also unbeatable when refitting an existing installation and as a "repair gland". There is no need to disassemble pre-mounted cables, it can be installed without interrupting the production process.



Type	SW mm	Dim. L mm		Dim. L1 L2 mm	
		min.	max.	L1	L2
V-TEC TB20	30	24.5	30.5	10	8.5

Dimensions

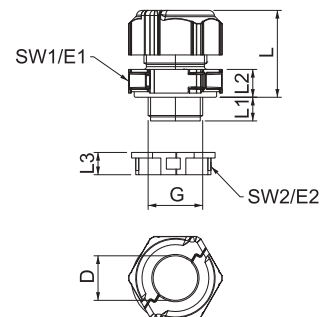

PC



Divisible cable gland, seal insert enclosed, light grey

Type	Colour	Shipping box		Pack Piece	Weight kg/100 pc.	Item no.
		Piece				
V-TEC TB25	Light grey	50		5	3.440	2024910

The splittable cable gland V-TEC TB.. ensures - like all V-TEC glands - a secure sealing of the cable. The installation of pre-terminated cables or function cables, for example, is easy and quick, thanks to the splitting of the cable gland.
The V-TEC TB is also unbeatable when refitting an existing installation and as a "repair gland". There is no need to disassemble pre-mounted cables, it can be installed without interrupting the production process.



Type	SW mm	E mm	Dim. L mm		Dim. L1 L2 mm	
			min.	max.	L1	L2
V-TEC TB25	35	39	31.5	40	11	10

Dimensions

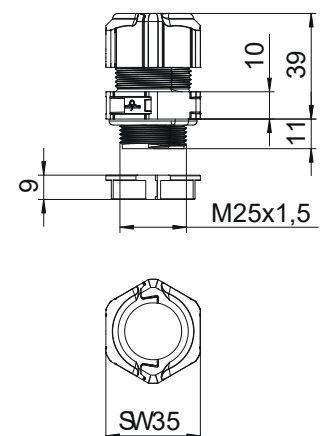



Cone cable gland, metric thread, light grey

Type	Thread	Colour	Pack Piece	Weight kg/100 pc.	Item no.
106 M12 PS	M12x1,5	Light grey	50	0.400	2035316
106 M16 PS	M16x1,5	Light grey	50	0.560	2035324
106 M 20 PS	M20x1,5	Light grey	50	0.753	2035332
106 M 25 PS	M25x1,5	Light grey	50	1.018	2035340
106 M 32 PS	M32x1,5	Light grey	10	2.891	2035359
106 M 40 PS	M40x1,5	Light grey	10	4.973	2035367
106 M 50 PS	M50x1,5	Light grey	5	6.594	2035375
106 M 63 PS	M63x1,5	Light grey	5	9.630	2035383

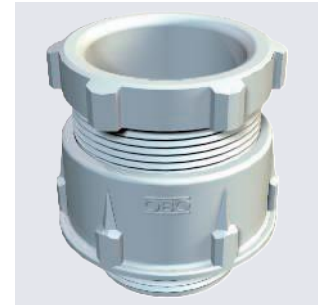

Standard cable gland, shape A, to DIN 46320 with simple NR/SBR sealing ring with metric connection thread to IEC 423.
 Protection rating: with connection thread sealing ring IP65, without connection thread sealing ring IP54.
 Note: Only tighten polystyrene cable glands lightly due to the risk of stress crack formation.

Type	Thread	Sealing range D	Dim. D2	Dim. D3	Dim. D4	SW 1	SW 2	Dim.				
								L max.	Dim. L1	Dim. L2	Dim. L3	Dimension L4
106 M12 PS	M12x1,5	3,5-6,5	16,5	7	7	15	13	23	8	13	5	8,5
106 M16 PS	M16x1,5	4,5-7	21,5	10,2	10	19	16	25	8	14	5	9
106 M 20 PS	M20x1,5	9-13	27	13,4	13,5	24	21	28	9	16	5	10,8
106 M 25 PS	M25x1,5	10-14	30	15,8	16	27	23	30	10	16,5	6	12
106 M 32 PS	M32x1,5	18-25	47,5	30,3	26	42	40	42	11	20,5	8	18
106 M 40 PS	M40x1,5	25-33	58	38,4	33	53	50	43	12	24	8	17
106 M 50 PS	M50x1,5	30-38	65	44,5	40,5	60	55	48	13	27	9	18,5
106 M 63 PS	M63x1,5	37-44	70	50	45,5	65	60	48	14	27	9	18,5

Dimensions

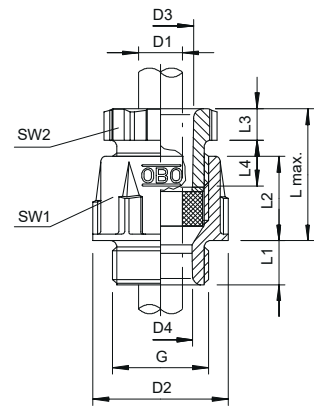

Cone cable gland, metric thread, cutting ring, nickel-plated

CuZn 37	N
IP 54	IP 65
M	

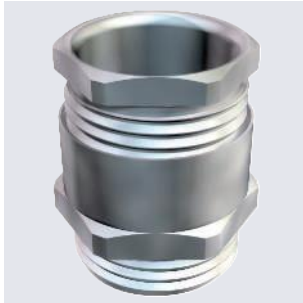

Type	Material	Pack Piece	Weight kg/100 pc.	Item no.
162 MS M12	Brass	50	1.200	2083706
162 MS M16	Brass	50	1.814	2083712
162 MS M20	Brass	25	2.294	2083716
162 MS M25	Brass	25	3.388	2083720
162 MS M32	Brass	10	5.004	2083724
162 MS M40	Brass	10	14.881	2083728
162 MS M50	Brass	5	15.800	2083732
162 MS M63	Brass	5	21.600	2083736

Cable gland with hexagonal intermediate connector, shape C4, to DIN 46320 with metric connection thread to DIN EN 60423 and ISO 68. Pressure rings made of electrogalvanised and transparently passivated steel. NR/SBR sealing ring.

Protection rating: with connection thread sealing ring IP 65, without connection thread sealing ring IP 54.

With cutting ring.

* Prices according to DEL notation.

Dimensions

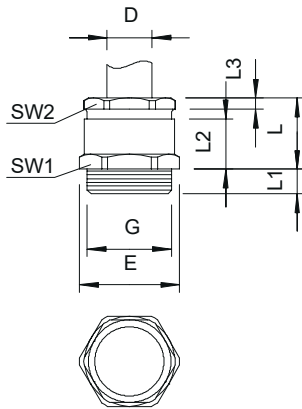

Type	Thread	Sealing range		Dim. E	Dim. L	Dim. L1	Dim. L2	Dim. L3
		D	SW					
162 MS M12	M12 x 1,5	5-7	14 13	15,5	15	7	16	2,5
162 MS M16	M16 x 1,5	5-8	18 15	20,2	16	7	16	3
162 MS M20	M20 x 1,5	7,5-13,5	22 20	24,4	18	7	18	3
162 MS M25	M25 x 1,5	10-20,5	32 28	35,5	22	8	22	2,5
162 MS M32	M32 x 1,5	18-29	40 37	43,5	24	8,5	24	3,5
162 MS M40	M40 x 1,5	24-31	50 47	54	29	8,5	29	3,5
162 MS M50	M50 x 1,5	30-42	57 54	61	33	9,5	33	4
162 MS M63	M63 x 1,5	36-47	65 60	69	35	10	10	4



PC



Universal plug-in terminal, 2-pole

Type	Colour	Pack Piece	Weight kg/100 pc.	Item no.
61 225 FL	Transparent	100	0.200	2054450

Tested according to EN 60998.

Screwless terminal to connect electrical conductors. The type of conductor can either be flexible, multi-wire or rigid.

If rigid conductors are used, an opening of the release lever is not necessary. The conductor can be plugged into the terminal directly.

To extract the conductors, simply open the release lever. The strand can then be easily pulled-out.

Nominal cross-section:

2 x 0.2 - 2.5 mm² multi-wire cables / single-wire conductors

Rated voltage 450 V.

Rated current 24 A.

Stripping length: 9 mm (+1 mm).

Inspection opening: Phase tester and testing pin (max. Ø 2 mm), very easily accessible on the top side of the terminal

Max. approved ambient temperature according to EN 60998: 85 °C.

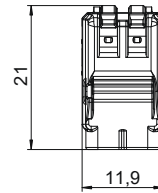
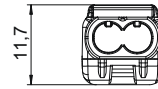

PC



Universal plug-in terminal, 3-pole

Type	Colour	Pack Piece	Weight kg/100 pc.	Item no.
61 325 FL	Transparent	75	0.270	2054454

Tested according to EN 60998.

Screwless terminal to connect electrical conductors. The type of conductor can either be flexible, multi-wire or rigid.

If rigid conductors are used, an opening of the release lever is not necessary. The conductor can be plugged into the terminal directly.

To extract the conductors, simply open the release lever. The strand can then be easily pulled-out.

Nominal cross-section:

3 x 0.2 - 2.5 mm² multi-wire cables / single-wire conductors

Rated voltage 450 V.

Rated current 24 A.

Stripping length: 9 mm (+1 mm).

Inspection opening: Phase tester and testing pin (max. Ø 2 mm), very easily accessible on the top side of the terminal

Max. approved ambient temperature according to EN 60998: 85 °C.

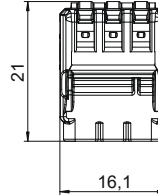
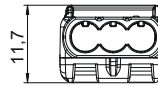

PC



Universal plug-in terminal, 5-pole

Type	Colour	Pack Piece	Weight kg/100 pc.	Item no.
61 525 FL	Transparent	50	0.410	2054458

Tested according to EN 60998.

Screwless terminal to connect electrical conductors. The type of conductor can either be flexible, multi-wire or rigid.

If rigid conductors are used, an opening of the release lever is not necessary. The conductor can be plugged into the terminal directly.

To extract the conductors, simply open the release lever. The strand can then be easily pulled-out.

Nominal cross-section:

5 x 0.2 - 2.5 mm² multi-wire cables / single-wire conductors

Rated voltage 450 V.

Rated current 24 A.

Stripping length: 9 mm (+1 mm).

Inspection opening: Phase tester and testing pin (max. Ø 2 mm), very easily accessible on the top side of the terminal

Max. approved ambient temperature according to EN 60998: 85 °C.

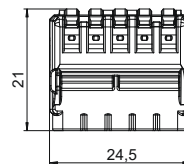

PA



Dolü branch terminals, open on both sides, 12-pin

Type	Colour	Shipping box Piece	Pack Piece	Weight kg/100 pc.	Item no.
70 VDE	Sorted	400	10	2.500	2055203

* Sorted in colours black, brown, blue and yellow-green.
 Terminals made of brass, screws of steel, galvanised and transparently passivated, 12-pole, strip separable into individual terminals, open on both sides.
 Captive upwards screw.
 Nominal cross-section 2.5 mm².
 Nominal voltage 380 V.
 Nominal current 16 A.
 Max. connectable cross-sections per terminal: 4 x 2.5 mm², 5 x 1.5 mm² or 6 x 1 mm².

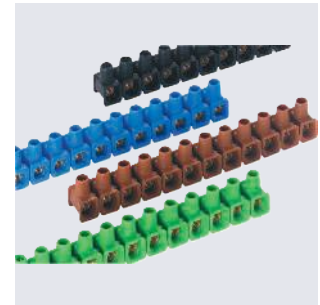
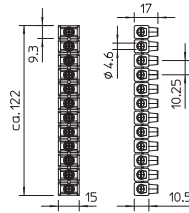

PP



Dolü branch terminals, open on both sides, 10-pin

Type	Colour	Shipping box Piece	Pack Piece	Weight kg/100 pc.	Item no.
71	Black	120	10	7.030	2055503

Terminals made of brass, screws of steel, galvanised and transparently passivated, 10-pole, strip separable into individual terminals, open on both sides.
 Captive upwards screw.
 Nominal cross-section 10 mm².
 Nominal voltage 380 V.
 Max. connectable cross-sections per terminal: 3 x 10 mm², 4 x 6 mm².

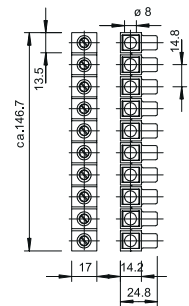

PA



Dolü branch terminals, open on one side

Type	Colour	Shipping box Piece	Pack Piece	Weight kg/100 pc.	Item no.
70 S	Sorted	180	10	2.852	2055201

Terminals made of brass, screws of steel, galvanised and transparently passivated, 12-pole, strip separable into individual terminals, only open on one side.
 Closed on one side, captive upwards screw.
 Nominal cross-section 2.5 mm².
 Nominal voltage 250 V.
 Nominal current 24 A.
 Max. connectable cross-sections per terminal: 4 x 2.5 mm², 5 x 1.5 mm² or 6 x 1 mm².
 Delivery sorted by colour: 3 black, 2 blue, 3 yellow-green, 1 brown and 1 grey strip in each packaging unit.

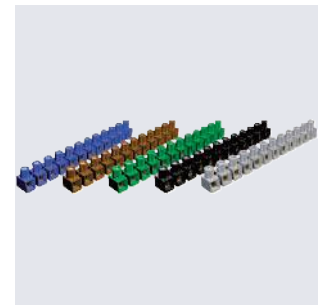
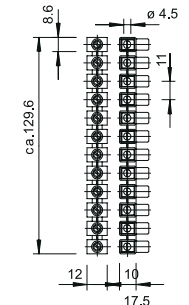

PP



4 mm² series connectors, polypropylene

Type	Colour	Shipping box Piece	Pack Piece	Weight kg/100 pc.	Item no.
72 CE WS/EKL 0 S	White	500	10	1.800	2056070

Tested according to EN 60998.
 Steel terminals, steel screws, electrogalvanised, 12-pin, individual terminals detachable from strips using "twist'n'pull".
 Captive upwards screw.
 Max. approved ambient temperature to EN 60998: -5 to +80 °C.
 Nominal cross-section 4 mm².
 Nominal voltage 450 V.
 Nominal current 32 A.
 Max. attachment each side: 4 mm² single-wire or 2.5 mm² multi-wire/flexible.

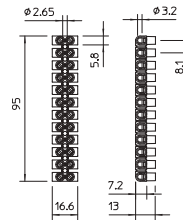

PP



4 mm² series connectors, polypropylene

Type	Colour	Shipping box Piece	Pack Piece	Weight kg/100 pc.	Item no.
72 CE SW/EKL 0 S	Black	500	10	1.800	2056089

Tested according to EN 60998.
 Steel terminals, steel screws, electrogalvanised, 12-pin, individual terminals detachable from strips using "twist'n'pull".
 Captive upwards screw.
 Max. approved ambient temperature to EN 60998: -5 to +80 °C.
 Nominal cross-section 4 mm².
 Nominal voltage 450 V.
 Nominal current 32 A.
 Max. attachment each side: 4 mm² single-wire or 2.5 mm² multi-wire/flexible.

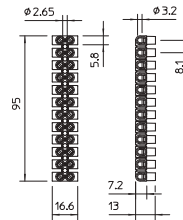

PA



4 mm² series connector, polyamide

Type	Colour	Shipping box Piece	Pack Piece	Weight kg/100 pc.	Item no.
72 VDE/EKL 0E PA	Transparent	500	10	2.000	2055929

Brass terminals, steel screws, galvanised and blue passivated, 12-pin, individual terminals detachable.
 Captive upwards screw.
 Nominal cross-section 4 mm².
 Rated voltage 450 V.
 Nominal current 32 A.
 Max. attachment each side: 4 mm² single-wire or 2.5 mm² multi-wire.
 Maximum approved ambient temperature to EN 60998: -5 to +85 °C.

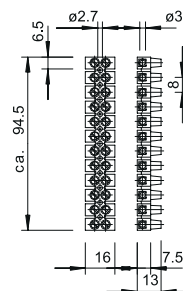

PA



Terminal strips, 4 mm², wire protection clamp, polyamide

Type	Colour	Shipping box Piece	Pack Piece	Weight kg/100 pc.	Item no.
74 D/EKL 1BEF2 D	Transparent	200	10	3.680	2056178

With wire protection clamp.
 Tested according to EN 60998.
 Brass terminals, steel screws, galvanised and blue passivated, 12-pin, individual terminals detachable.
 Captive upwards screw.
 Nominal cross-section 4 mm².
 Nominal voltage 450 V.
 Nominal current 32 A.
 Max. attachment each side: 4 mm² single-wire or 4 mm² fine-wire.
 Maximum approved ambient temperature to EN 60998: -5 to +85 °C.

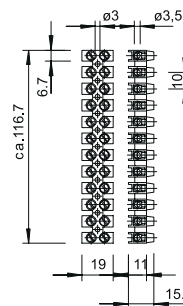

Main branch terminal, 1-pole

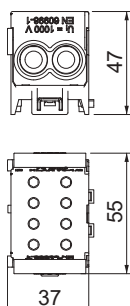
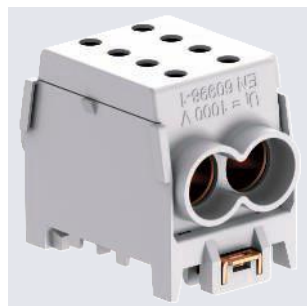

Type	Max. conductor cross-section mm ²	Number of screwless terminals per pole	Pole number	Pack Piece	Weight kg/100 pc.	Item no.
HLAK 1-2x35 GR	50	4	1	1	11.600	2009042
HLAK 1-2x35 GRGN	50	4	1	1	11.600	2009044
HLAK 1-2x35 GRBL	50	4	1	1	11.600	2009046

1-pin main terminal block, 4 x 50 mm² conductor connection cross-sections per pin. With 2 screws per terminal for secure contact pressure. High-resistance quick-action fastening made of galvanised sheet steel for simple mounting on support rails. Terminal covers are available in the standard conductor colours.

Main branch terminal, 4-pole

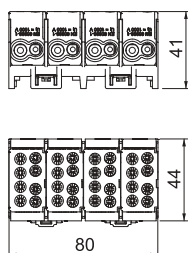

Type	Max. conductor cross-section mm ²	Number of screwless terminals per pole	Pole number	Pack Piece	Weight kg/100 pc.	Item no.
HLAK 4-8x16	25	4	4	1	19.200	2009032

4-pin main terminal block, 2 x 16 mm² + 2 x 25 mm² conductor connection cross-sections per pin. With 2 screws per terminal for secure contact pressure. High-resistance quick-action fastening made of galvanised sheet steel for simple mounting on support rails. Terminal covers are available in the standard conductor colours.

Main branch terminal, 5-pole

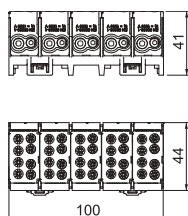
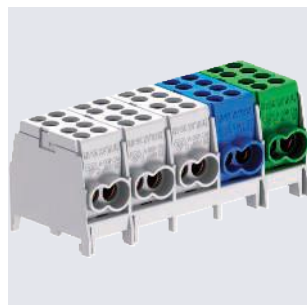

Type	Max. conductor cross-section mm ²	Number of screwless terminals per pole	Pole number	Pack Piece	Weight kg/100 pc.	Item no.
HLAK 5-10x16	25	4	5	1	23.100	2009036

5-pin main terminal block, 2 x 16 mm² + 2 x 25 mm² conductor connection cross-sections per pin. With 2 screws per terminal for secure contact pressure. High-resistance quick-action fastening made of galvanised sheet steel for simple mounting on support rails. Terminal covers are available in the standard conductor colours.

Main branch terminal, 5-pole

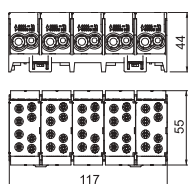
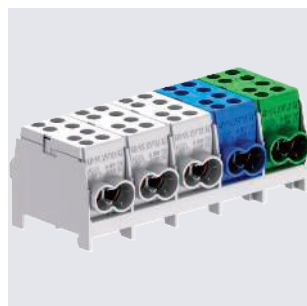

Type	Max. conductor cross-section mm ²	Number of screwless terminals per pole	Pole number	Pack Piece	Weight kg/100 pc.	Item no.
HLAK 5-10x25	35	4	5	1	38.100	2009038

5-pin main terminal block, 2 x 35 mm² + 2 x 25 mm² conductor connection cross-sections per pin. With 2 screws per terminal for secure contact pressure. High-resistance quick-action fastening made of galvanised sheet steel for simple mounting on support rails. Terminal covers are available in the standard conductor colours.

PS



Concealed accessory/connection socket

Type	Colour	Number of entries	Pipe Ø	Pack Piece	Weight kg/100 pc.	Item no.
UG 60 VD	Black	13	20/25 mm	25	1.790	2003019

Device/connection socket with torsion-resistant guaranteed standard combination spacing of 71 mm (to DIN 49 073-1) through Snap-lock coupling. Break-out openings for cables and pipes Ø 20 mm and Ø 25 mm. Combinable for spreading and screw fastening, low-lying plaster brackets, device bolt spacing 60 mm, for screw fastening with 3.2 mm self-tapping screws, with 2 screw bosses without screws, protection rating IP20.

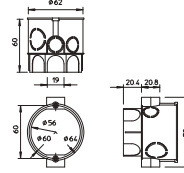

PS



Concealed accessory/connection socket with nail strap

Type	Colour	Number of entries	Pipe Ø	Pack Piece	Weight kg/100 pc.	Item no.
UG 60 VD NL	Black	13	20/25 mm	100	2.040	2003035

Device/connection socket with nail straps. These are used as a mounting aid to prefix the sockets. Nail diameter max. 3 mm, plaster thickness min. 8 mm, with increased socket volume to accept connection terminals. Torsion-resistant guaranteed standard combination spacing of 71 mm (to DIN 49 073-1) through Snap-lock coupling. 13 break-out openings for cables and pipes Ø 20 mm and Ø 25 mm. Combinable for spreading and screw fastening, low-lying plaster brackets, device bolt spacing 60 mm, for screw fastening with 3.2 mm self-tapping screws, with 2 screw bosses without screws, protection rating IP20.

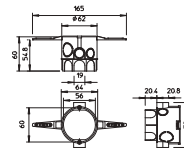

PS



Concealed accessory/connection box

Type	Colour	Number of entries	Pipe Ø	Pack Piece	Weight kg/100 pc.	Item no.
UG 60 VK	Black	8	20 mm	10	4.600	2003023

Device/connection socket with increased socket volume on both sides of the device installation opening to accept connection terminals. Torsion-resistant guaranteed standard combination spacing of 71 mm (to DIN 49 073-1) through snap-lock coupling. Break-out openings for cables and pipes of up to Ø 21 mm, low-lying plaster brackets, device bolt spacing 60 mm, for screw fastening with 3.2 mm self-tapping screws, with 4 screw bosses and 2 device screws, protection rating IP20.

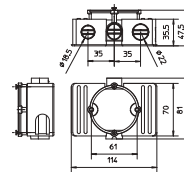

PC



Distribution box, 3 division units, with screwless terminal

Type	Terminals	Colour	Dimension	Pack	Weight	Item no.
			LxWxH mm			
SDB 03 PC	Connector	Light grey	150x190x125	1	75.540	2008840

Surface-mounted distribution box, with protective insulation for max. 3 division units. There are 3 break-out openings (2x Ø20 and 1x Ø20/25) on both the upper and lower sides incl. pre-mounted 35 mm hat profile support rail. The four screw cover caps supplied prevent unwanted "voltage carry over".

Suitable for interior and exterior mounting
VDE-tested to DIN EN 61439

Accessories:

- Terminal strip set consisting of: One PE/N terminal (1x25 mm² and 1x16 mm² screw terminal points, 2x4 mm² and 12x2.5 mm² screwless terminals), mini hat profile rail, mounting instructions and fastening set
- Self-adhesive pictograms for installation labelling
- Two elastic cable entries Ø20 mm for cable diameters 0–17 mm
- One elastic cable entry Ø25 mm for cable diameter 0–22 mm
- Two stainless steel external fastenings
- Cover strip for closing off unused separation units



PC



Distribution box, 5 division units, with screwless terminal

Type	Terminals	Colour	Dimension	Pack	Weight	Item no.
			LxWxH mm			
SDB 05 PC	Connector	Light grey	190x150x125	1	76.040	2008844

Surface-mounted distribution box, with protective insulation for max. 5 division units. There are 5 break-out openings (4x Ø20 and 1x Ø20/25) on both the upper and lower sides incl. pre-mounted 35 mm hat profile support rail. The four screw cover caps supplied prevent unwanted "voltage carry over".

Suitable for interior and exterior mounting
VDE-tested to DIN EN 61439

Accessories:

- Terminal strip set consisting of: One PE/N terminal (1x25 mm² and 1x16 mm² screw terminal points, 2x4 mm² and 12x2.5 mm² screwless terminals), mini hat profile rail, mounting instructions and fastening set
- Self-adhesive pictograms for installation labelling
- Four elastic cable entries Ø20 mm for cable diameters 0–17 mm
- One elastic cable entry Ø25 mm for cable diameter 0–22 mm
- Two stainless steel external fastenings
- Cover strip for closing off unused separation units



PC



Distribution box, 9 division units, with screwless terminal

Type	Terminals	Colour	Dimension	Pack	Weight	Item no.
			LxWxH mm			
SDB 09 PC	Connector	Light grey	240x191x125	1	103.840	2008848

Surface-mounted distribution box, with protective insulation for max. 9 division units. There are 9 break-out openings (8x Ø20 and 1x Ø20/25/32) on both the upper and lower sides incl. pre-mounted 35 mm hat profile support rail. The four screw cover caps supplied prevent unwanted "voltage carry over".

Suitable for interior and exterior mounting
VDE-tested to DIN EN 61439

Accessories:

- Terminal strip set consisting of: One PE/N terminal (1x25 mm² and 1x16 mm² screw terminal points, 2x4 mm² and 12x2.5 mm² screwless terminals), mini hat profile rail, mounting instructions and fastening set
- Self-adhesive pictograms for installation labelling
- Six elastic cable entries Ø20 mm for cable diameters 0–17 mm
- One elastic cable entry Ø25 mm for cable diameter 0–22 mm
- One elastic cable entry Ø32 mm for cable diameter 0–28 mm
- Two stainless steel external fastenings
- Cover strip for closing off unused separation units



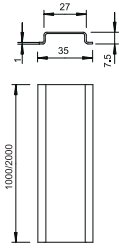

Hat profile rail 35 x 7.5 mm to DIN EN 60715 (formerly DIN EN 50022).

Hat profile rail, unperforated

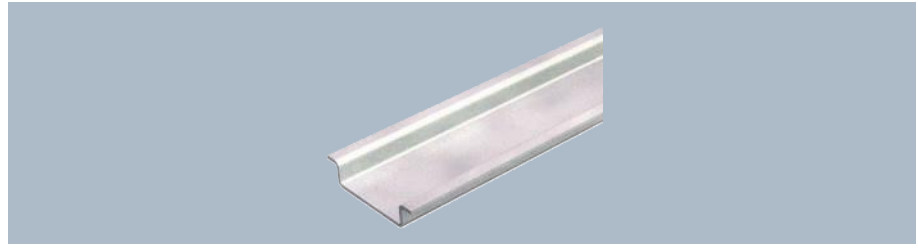

Type	Version	Material thickness mm	Length mm	Bundle m	Weight kg/100 m	Item no.
2069 2M BK	Unperforated	1	2000	50	36.040	1115618
2069 3M BK	Unperforated	1	3000	—	36.034	1115855

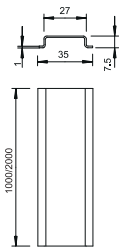

Hat profile rail 35 x 7.5 mm to DIN EN 60715 (formerly DIN EN 50022).

Hat profile rail, unperforated

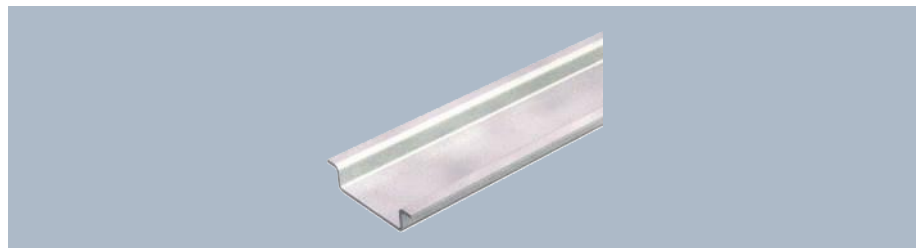

Type	Version	Material thickness mm	Length mm	Bundle m	Weight kg/100 m	Item no.
2069 1M FS	Unperforated	1	1000	25	36.020	1115677
2069 2M FS	Unperforated	1	2000	50	36.033	1115626

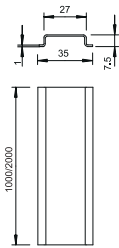

Hat profile rail 35 x 7.5 mm to DIN EN 60715 (formerly DIN EN 50022).

Hat profile rail, unperforated

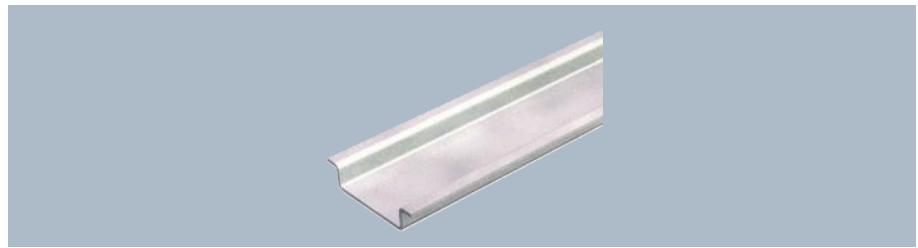

Type	Version	Material thickness mm	Length mm	Bundle m	Weight kg/100 m	Item no.
2069 1M GTP	Unperforated	1	1000	25	36.020	1115685
2069 2M GTP	Unperforated	1	2000	50	36.040	1115650



Hat profile and support rail cutting unit

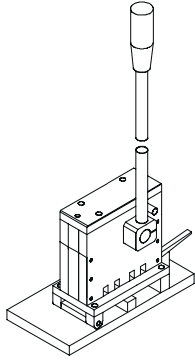
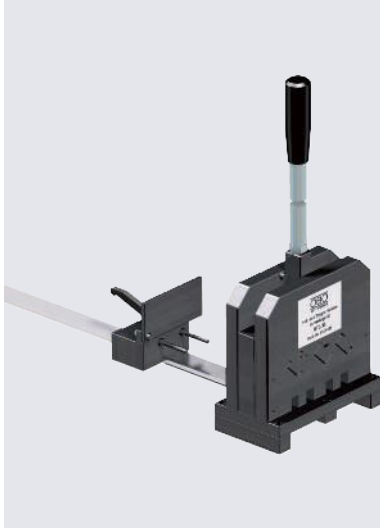

Type	Pack Piece	Weight kg/100 pc.	Item no.
HTS 35	1	2,000.000	1125036

With the HTS 35 hat and support rail cutting device, you can cut the four most common hat and support rail profiles (types 2069..., 46277... and 2064...) to fit and without burring in accordance with DIN 50022 and DIN 50035.

OBO Bettermann Holding GmbH Co. KG

P.O. Box 1120
58694 Menden, Germany

Customer Service

Tel.: +49 23 73 89 - 17 00
Fax: +49 23 73 89 - 12 38
export@obo.de

www.obo-bettermann.com

Building Connections

